

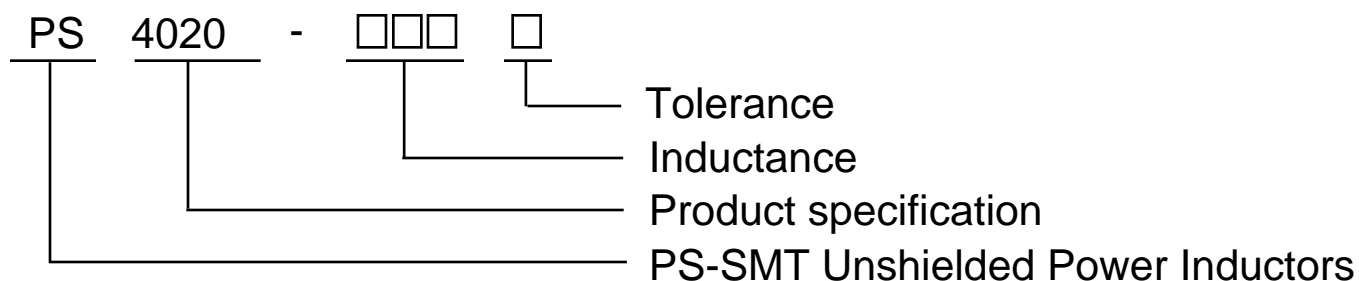

SMT Power Inductors-PS4020

产品型号

PRODUCT IDENTIFICATION



Tolerance:

Code	Tolerance
102	1.0uH
103	10.0uH
104	100.0uH
105	1000.0uH
106	10000.0uH

Inductance:

Code	Tolerance
J	±5%
K	±10%
L	±15%
M	±20%
N	±30%

外观尺寸

SHAPE AND DIMENSIONS

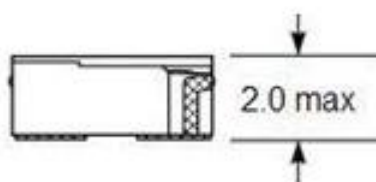
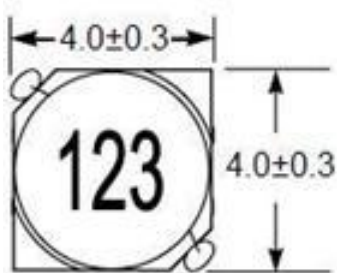

Unit : mm

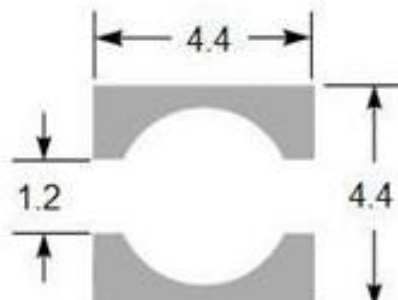
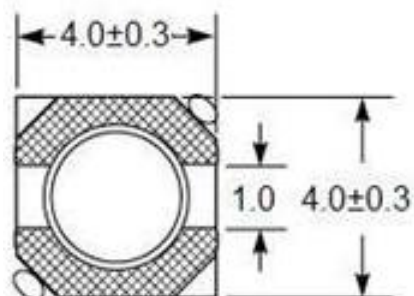

Recommended Land Pattern



深圳市富尔电子科技有限公司

ADD: 广东省深圳市南山区后海工业七路8号

Http://www.frcoil.com

Tel/Fax: 0755-21606613/21606608

Email: xy@frcoil.com



SMT Power Inductors-PS4020

规格特性

SPECIFICATIONS

Part number	Inductance ¹ ±20% (μH)	DCR max (Ohms)	SRF typ ² (MHz)	Isat (A) ³			Irms (A) ⁴	
				10% drop	20% drop	30% drop	20°C rise	40°C rise
PS4020-332M	3.3	0.085	109.0	0.94	1.10	1.20	1.25	1.60
PS4020-472M	4.7	0.115	93.0	0.73	0.87	0.95	1.10	1.50
PS4020-562M	5.6	0.130	85.0	0.70	0.82	0.89	1.05	1.40
PS4020-682M	6.8	0.175	75.0	0.65	0.76	0.83	0.96	1.30
PS4020-822M	8.2	0.190	70.0	0.61	0.71	0.77	0.89	1.20
PS4020-103M	10	0.210	63.0	0.50	0.60	0.67	0.86	1.15
PS4020-123M	12	0.280	55.0	0.47	0.55	0.60	0.75	1.00
PS4020-153M	15	0.330	50.0	0.45	0.53	0.58	0.71	0.95
PS4020-183M	18	0.360	42.0	0.40	0.47	0.52	0.67	0.85
PS4020-223M	22	0.480	38.0	0.39	0.45	0.49	0.60	0.80
PS4020-273M	27	0.560	35.0	0.30	0.36	0.39	0.54	0.71
PS4020-333M	33	0.620	31.0	0.29	0.34	0.38	0.50	0.67
PS4020-393M	39	0.820	28.5	0.28	0.32	0.36	0.44	0.58
PS4020-473M	47	0.930	28.0	0.25	0.28	0.31	0.42	0.56
PS4020-563M	56	1.200	22.0	0.23	0.27	0.29	0.35	0.47
PS4020-683M	68	1.330	18.0	0.20	0.24	0.26	0.32	0.43
PS4020-823M	82	1.500	17.0	0.18	0.21	0.23	0.30	0.40
PS4020-104M	100	2.100	15.0	0.15	0.18	0.20	0.27	0.36

- 4 × 4 mm footprint; 2 mm high shielded inductors
- Low DCR and excellent current handling

1. Inductance measured at 100 kHz, 0.1 Vrms, 0 Adc using a Frcoil SMD-A fixture in an Agilent/HP 4263B LCR meter or equivalent.
2. SRF measured using an Agilent/HP 8753D network analyzer and a Frcoil SMD-D test fixture.
3. DC current at which the inductance drops the specified amount from its value without current.
4. Current that causes the specified temperature rise from 25°C ambient.
5. Electrical specifications at 25°C.

Designer's Kit C381 contains 3 each of all values.

Core material Ferrite

Terminations RoHS compliant matte tin over nickel over phosphor bronze. Other terminations available at additional cost.

Weight: 81.0 – 87.8 mg

Ambient temperature –40°C to +85°C with Irms current, +85°C to +125°C with derated current

Storage temperature Component: –40°C to +125°C.
Packaging: –40°C to +80°C

Resistance to soldering heat Max three 40 second reflows at +260°C, parts cooled to room temperature between cycles

Moisture Sensitivity Level (MSL) 1 (unlimited floor life at <30°C / 85% relative humidity)

Failures in Time (FIT) / Mean Time Between Failures (MTBF)
38 per billion hours / 26,315,789 hours, calculated per Telcordia SR-332



深圳市富尔电子科技有限公司

ADD: 广东省深圳市南山区后海工业七路8号

Http://www.frcoil.com

Tel/Fax: 0755-21606613/21606608

Email: xy@frcoil.com



SMT Power Inductors-PS4020

电气特性

TYPICAL ELECTRICAL CHARACTERISTICS

Typical L vs Current

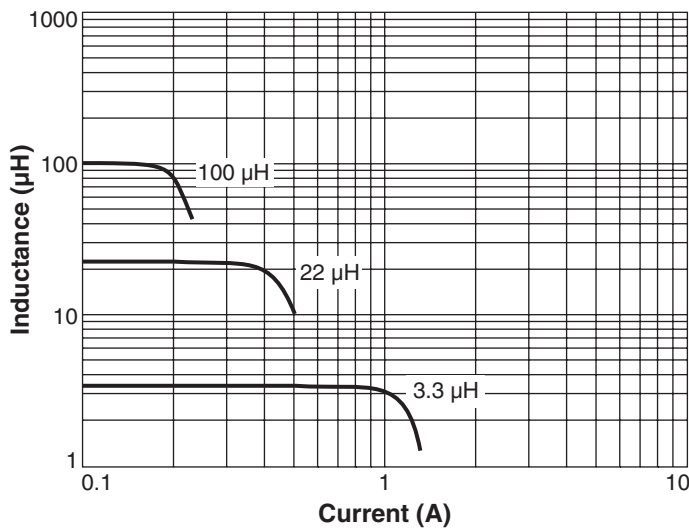

Typical L vs Frequency

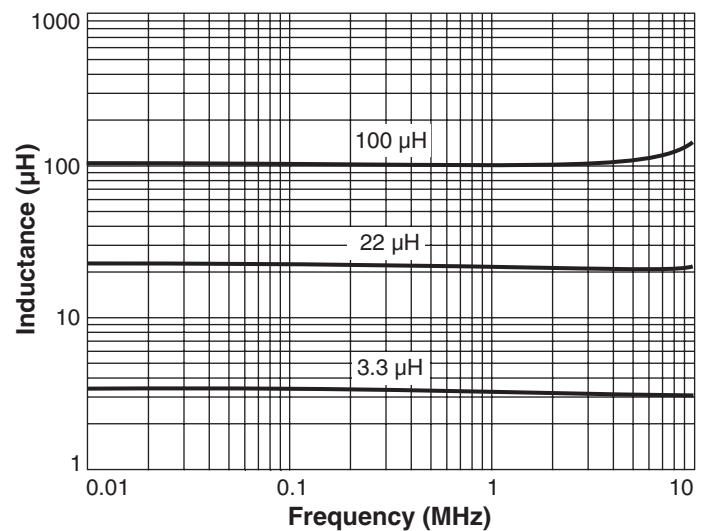

Current Derating

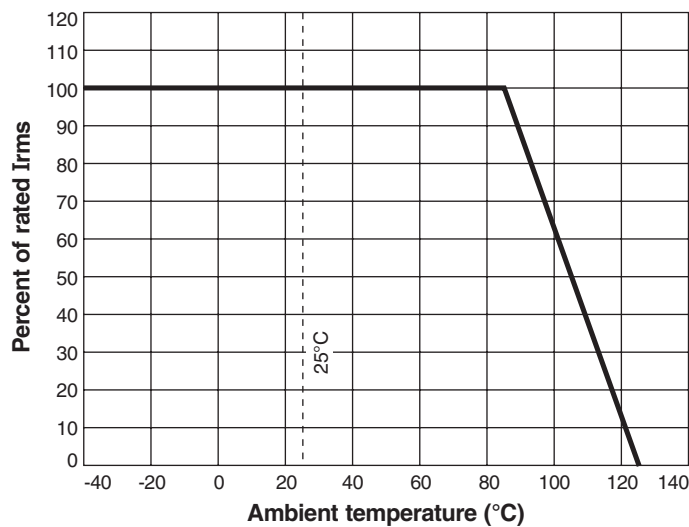



深 圳 市 富 尔 电 子 科 技 有 限 公 司

ADD: 广东省深圳市南山区后海工业七路8号

[Http://www.frcoil.com](http://www.frcoil.com)

Tel/Fax: 0755-21606613/21606608

Email: xy@frcoil.com



SMT Power Inductors-PS4020